



*How clean and dry
is your gear?*

1-888-EZEE-DRY
1-888-3933-379
ramairgeardryer.com

R-SBSTK - Rinse Station (with stickman)

Instructions

1. Ensure stand is in the fully open position.

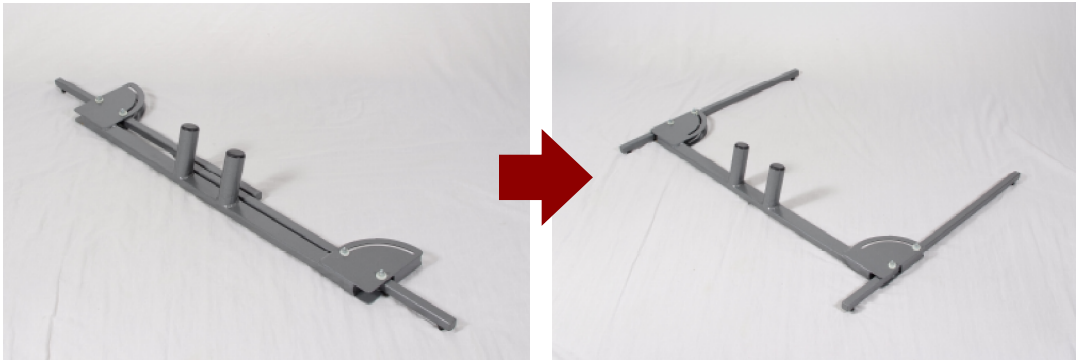

2. Place stickman caps in the top position.





*How clean and dry
is your gear?*

1-888-EZEE-DRY
1-888-3933-379
ramairgeardryer.com

R-SBSTK - Rinse Station (with stickman)

Instructions

3. Stickman can be used in a standing or inverted position.
Invert stickman for any garments with attached boots or gloves.



4. Articulate legs on stickman for desired length.





*How clean and dry
is your gear?*

1-888-EZEE-DRY
1-888-3933-379
ramairgeardryer.com

R-SBSTK - Rinse Station (with stickman)

Instructions

5. Place dressed stickman into stand.

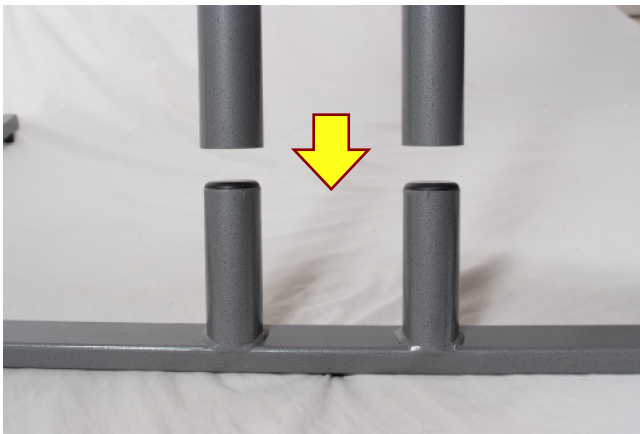

6. Rinse Garment. Follow the manufactures recommendations for cleaning and disinfecting. Inspect garment to ensure proper cleaning has been accomplished prior to drying.
7. Ensure no pockets of water remain trapped in garment. Shake garment to allow excess water to drain
8. Placed dressed and clean garment into dryer model 4-IHT. Follow dryer instructions.



9. Stand can be folded into the closed position for easy storage.